

# 2003 XLH MODELS

---

## SERVICE MANUAL

---

### Part Number 99484-03

Section 1: Product

Section 2: Chassis

Section 3: Engine

Section 4: Fuel System

Section 5: Starter

Section 6: Drive/Transmission

Section 7: Electrical

Appendix

## ELECTRICAL DIAGNOSTICS

---

### Part Number 99495-03

Section 1: Starting & Charging

Section 2: Instruments

Section 3: Turn Signals

Section 4: Engine Management

Section 5: Wiring



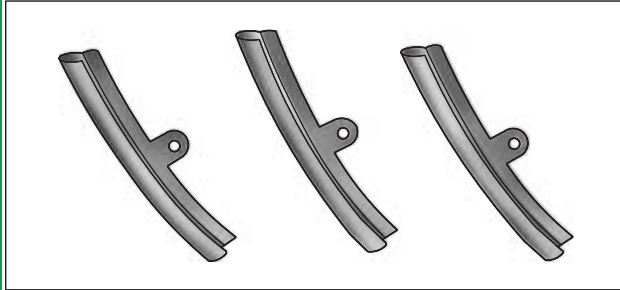

Part No. HD-01289 Rim Protectors

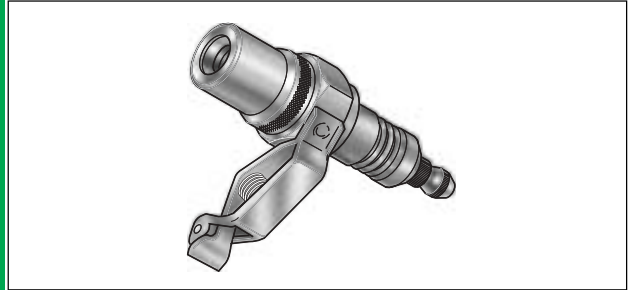

Part No. HD-26792 Spark Tester

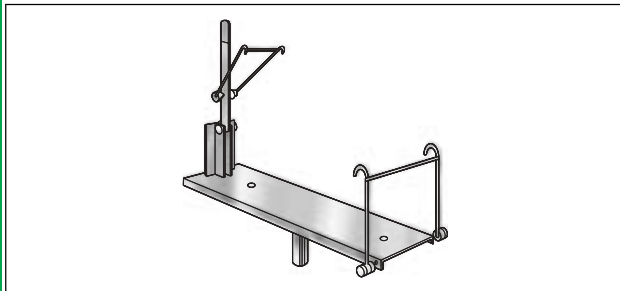

Part No. HD-21000 Tire Spreader

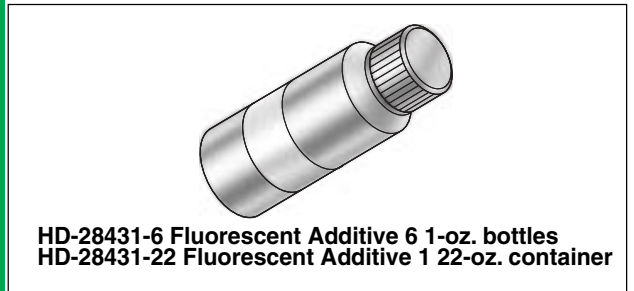

HD-28431-6 Fluorescent Additive 6 1-oz. bottles  
 HD-28431-22 Fluorescent Additive 1 22-oz. container

Part No. HD-28431-B Black Light Fluorescent Additive  
 (Use with HD-35457)

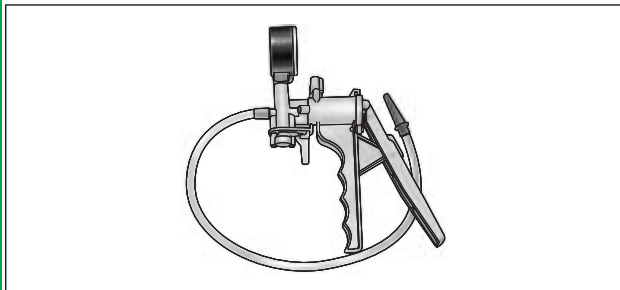

Part No. HD-23738-A Mity-Vac Vacuum Pump

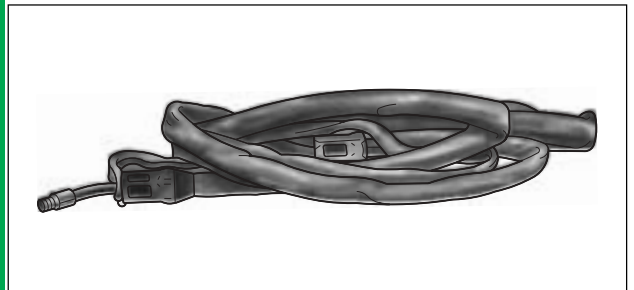

Part No. HD-28700 Tire Bead Expander

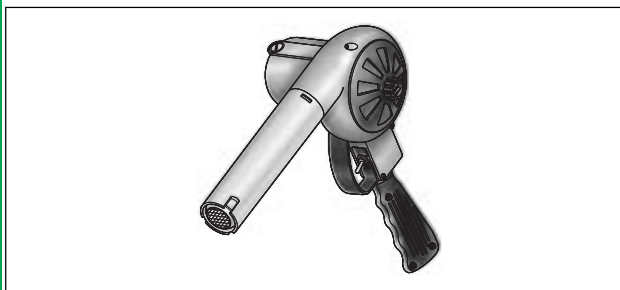

Part No. HD-25070 Robinair Heat Gun  
 (Use with HD-41183)

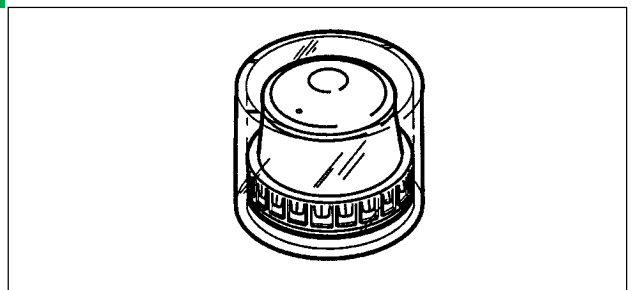

Part No. HD-33067 Wheel Bearing Packer

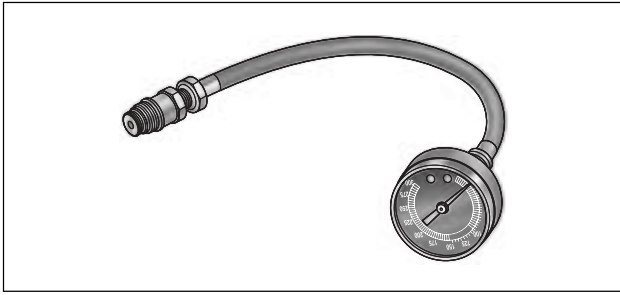

Part No. HD-33223-1 Cylinder Compression Gauge

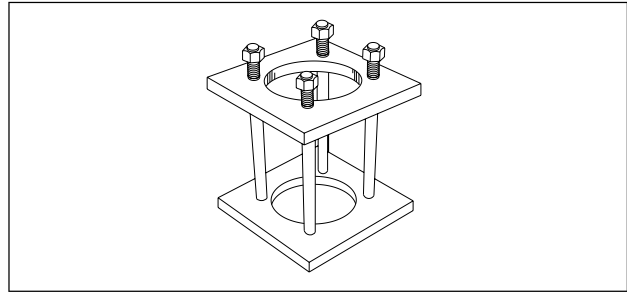

Part No. HD-33446-B Cylinder Torque Plates

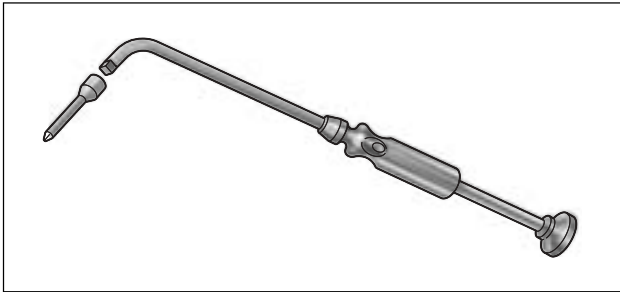

Part No. HD-33413-A Carburetor Idle Adjuster and Part No. HD-33413-1A Adjuster Tip

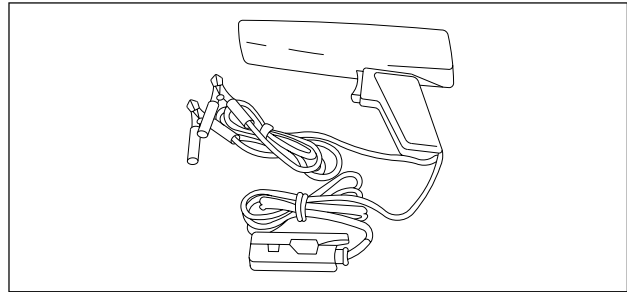

Part No. HD-33813 Inductive Timing Light

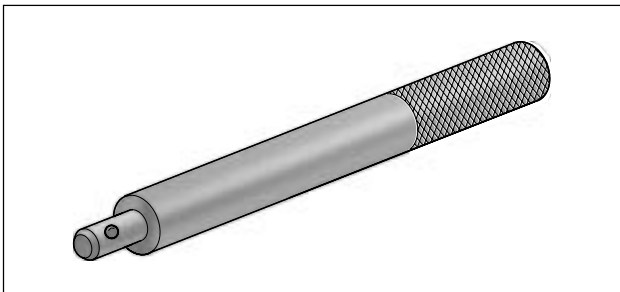

Universal Driver Handle  
4 in. length (Part No. HD-45907), 7 in. length (Part No. HD-44567), 12 in. length (Part No. HD-33416)

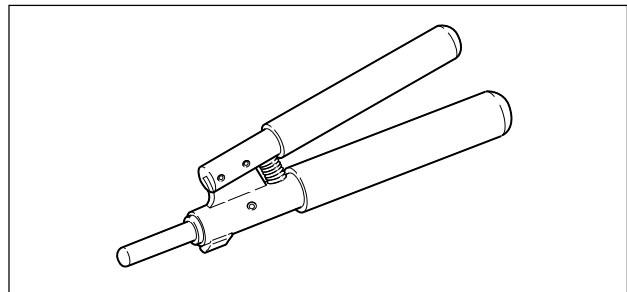

Part No. HD-34623-C Piston Pin Retaining Ring Installer

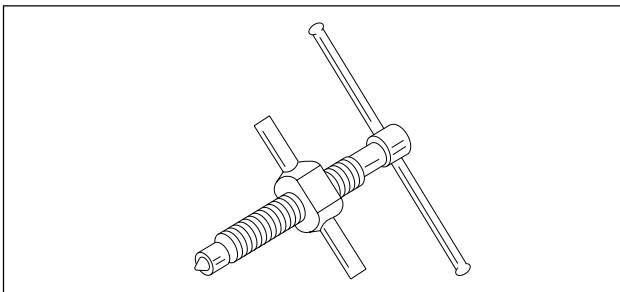

Part No. HD-33418 Universal Puller Forcing Screw

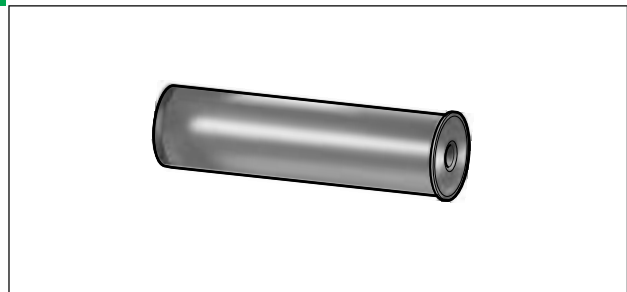

Part No. HD-34643-A Valve Stem Seal Installer  
(Use with HD- 34740-A)

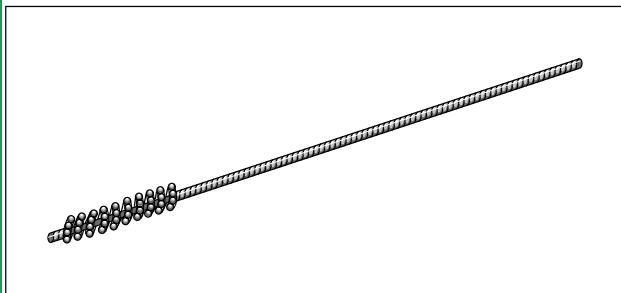

Part No. HD-34723-A Valve Guide Hone (8 mm)

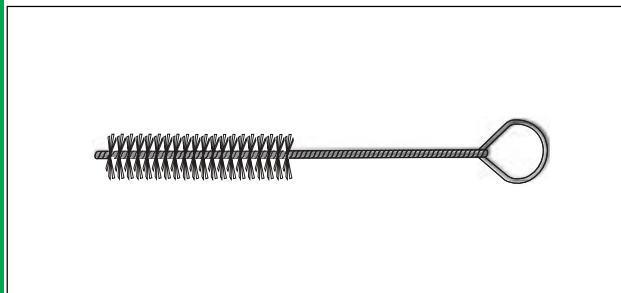

Part No. HD-34751-A Nylon Valve Guide Cleaning Brush

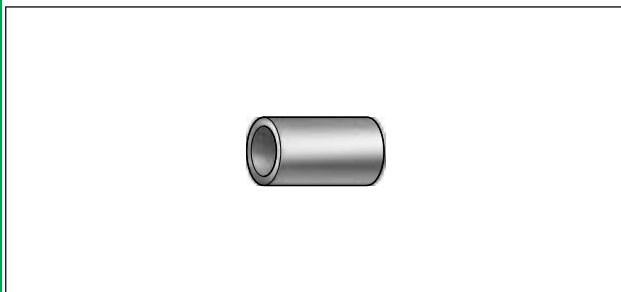

Part No. HD-34731-A Shoulderless Valve Guide Installer  
(Use with HD-34740-A)

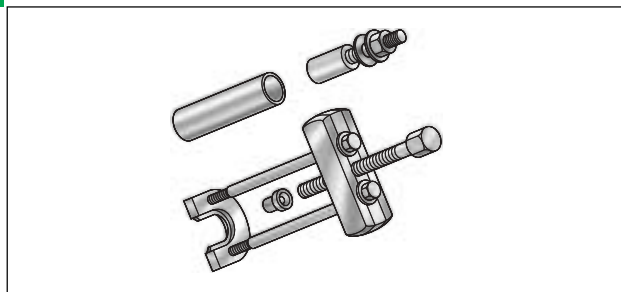

Part No. HD-34902-B Mainshaft Primary Bearing Race  
Remover And Installer

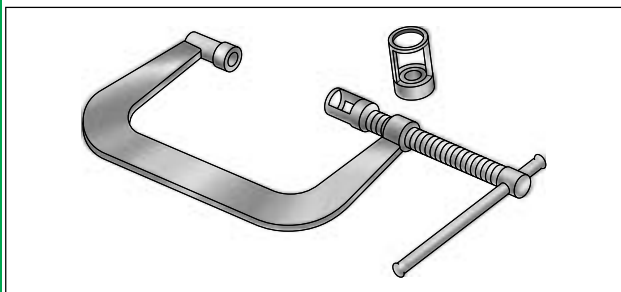

Part No. HD-34736-B Valve Spring Compressor

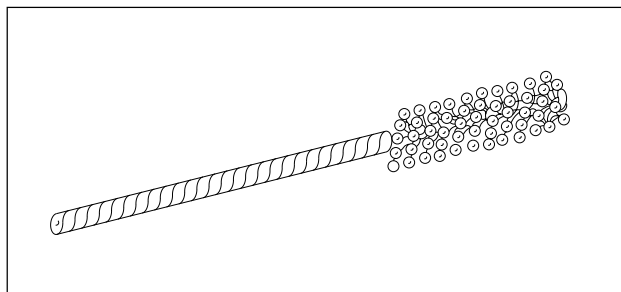

Part No. HD-35102 Wrist Pin Bushing Hone (20 mm)

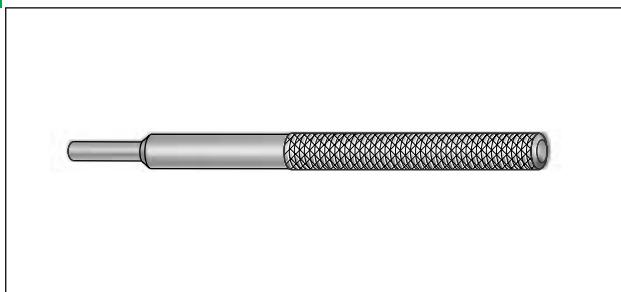

Part No. HD-34740-A Driver Handle and Remover. Used  
with HD-34643-A and HD-34731-A

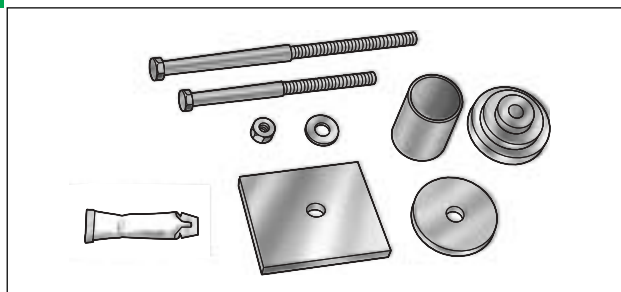

Part No. HD-35316-A Main Drive Gear Remover/Installer  
and Main Drive Gear Bearing Installer

It's a preview. You can download the full file by clicking the link below.

<https://shopservicemanual.com/>

Service Manuals from 2\$