

2017 Trike Model Parts Catalog

Alphabetical List

Parts

Hardware List

New Parts List

Numerical Index

Component Types and Introduction Dates

Common Service Parts

AIR CLEANER

AIR CLEANER COVER

AIR FILTER, ENGINE

ALTERNATOR AND REGULATOR

AUXILIARY/FOG LAMPS AND TURN SIGNALS, FRONT - DOMESTIC - FLHTCUTG

AXLE ASSEMBLY, REAR

BALANCER ASSEMBLY

BATTERY

BATTERY CABLES

BELT, CHAINS AND SPROCKETS

BELT, REAR 139 TEETH

BODY ASSEMBLY AND SIDE COVERS - FLHTCUTG

BODY ASSEMBLY AND SIDE COVERS - FLRT (1 OF 2)

BODY ASSEMBLY AND SIDE COVERS - FLRT (2 OF 2)

BODY CONTROL MODULE (BCM)

BRAKE CALIPER, FRONT

BRAKE CALIPER, REAR

BRAKE CONTROL, FRONT

BRAKE CONTROL, REAR - FLHTCUTG

BRAKE CONTROL, REAR - FLRT

BRAKE DISC, FRONT

BRAKE LINE, FRONT

BRAKE LINE, REAR - FLHTCUTG

BRAKE LINE, REAR - FLRT

BRAKE ROTOR, REAR

BRAKE, MASTER CYLINDER, REAR - FLHTCUTG

BRAKE, MASTER CYLINDER, REAR - FLRT

BRAKE, MASTER CYLINDER, W/ HAND LEVER, FRONT

CAMSHAFT SUPPORT ASSEMBLY

CAMSHAFTS AND CAMSHAFT COVER

CHAIN, PRIMARY

CHECK VALVE, OIL PRESSURE

CLUTCH

CLUTCH CONTROL

CLUTCH CONTROL HAND LEVER

CLUTCH LINE

CONSOLE, FUEL TANK - FLHTCUTG

COOLANT DISTRIBUTION, AIR-COOLED

COOLANT DISTRIBUTION, TWIN-COOLED™

COOLING SYSTEM, ENGINE, AIR-COOLED

COOLING SYSTEM, ENGINE, TWIN-COOLED™

COVER, PUSHRODS
CRANKCASE AND ENGINE OIL FILTER
CRANKCASE
CYLINDER HEADS
CYLINDERS, HEADS AND VALVES
DIPSTICK
ELECTRONIC CONTROL MODULE (ECM) AND COIL
ENGINE ASSEMBLY, AIR-COOLED
ENGINE ASSEMBLY, TWIN-COOLED™
ENGINE MOUNTS AND STABILIZER LINK
EVAPORATIVE EMISSIONS COMPONENTS
EXHAUST SYSTEM
FAIRING LOWERS - TWIN-COOLED™ - FLHTCUTG (1 OF 2)
FAIRING LOWERS - TWIN-COOLED™ - FLHTCUTG (2 OF 2)
FAIRING, INNER - FLHTCUTG (1 OF 2)
FAIRING, INNER - FLHTCUTG (2 OF 2)
FAIRING, OUTER - FLHTCUTG
FAN, OIL COOLER
FENDERS, FRONT
FENDERS, REAR - FLHTCUTG
FENDERS, REAR - FLRT
FLYWHEEL
FOOTBOARDS
FORK BRACKETS, FRONT
FORK, FRONT, LEFT AND RIGHT
FORK, REAR
FRAME, FRONT
FRAME, INTERMEDIATE AND FORK, REAR
FRAME, INTERMEDIATE
FRAME, MAIN
FRAME, REAR
FUEL FILTER
FUEL FILTER
FUEL INJECTOR
FUEL PUMP - FLHTCUTG
FUEL PUMP - FLRT
FUEL TANK - FLHTCUTG
FUEL TANK - FLRT
FUEL TANK TRIM - FLHTCUTG
FUEL TANK TRIM - FLRT
GAUGE, FUEL - FLHTCUTG
GAUGE, FUEL - FLRT
GAUGE, VOLTMETER - FLHTCUTG
GRIPS, HANDLEBAR
GUARD, ENGINE
HANDLEBAR
HEADLAMP - FLHTCUTG
HEADLAMP - FLRT
HEADLAMPS AND TURN SIGNALS, FRONT - HDI, ENGLAND, JAPAN - FLRT
HEADLAMPS AND TURN SIGNALS, FRONT - HDI, JAPAN - FLHTCUTG
HEADSET, SOUND SYSTEM
HORN
IGNITION COIL
INDICATOR LAMPS - FLRT
INDUCTION MODULE, FUEL

INSTRUMENT CLUSTER
INSTRUMENTS - FLHTCUTG
INSTRUMENTS, FUEL TANK - FLRT
JET, PISTON COOLING
LABELS
LAMPS AND SPEAKER HOUSINGS, ULTRA TOUR-PAK - FLHTCUTG (1 OF 2)
LAMPS AND SPEAKER HOUSINGS, ULTRA TOUR-PAK - FLHTCUTG (2 OF 2)
LATCH ASSEMBLY, TRUNK DOOR - FLHTCUTG
LICENSE PLATE LIGHT - HDI, JAPAN - FLRT
LOCK SET, COMPLETE
LOCK, TRUNK - FLHTCUTG
LOCK, TRUNK - FLRT
LOOSE PARTS
MAIN FUSE
MAIN FUSE
MIRRORS
MODULE, SECURITY SYSTEM
MODULE, TURN SIGNAL CANCELLER
MUFFLERS
NACELLE - FLRT
OIL COOLER
OIL FILTER, ENGINE
OIL PAN, TRANSMISSION
OIL PUMP
PARKING BRAKE
PISTONS AND FLYWHEEL ASSEMBLY
PRIMARY COVER
PRIMARY HOUSING
PUSHRODS
RADIATOR, COOLANT HOSES AND BOTTLE, TWIN-COOLED™
RADIO CONTROL, PASSENGER
REGULATOR, VOLTAGE
REMOTE CONTROL FOB
REVERSE CONTROL MODULE
REVERSE MOTOR
ROCKER ARM ASSEMBLY AND PUSHRODS
ROTOR, ENGINE
SEAT
SENSOR, AIR TEMP
SENSOR, COOLANT TEMPERATURE
SENSOR, CRANKSHAFT POSITION
SENSOR, ENGINE TEMP
SENSOR, KNOCK
SENSOR, SPEED
SENSOR, TEMPERATURE MANIFOLD ABSOLUTE PRESSURE
SENSOR, TEMPERATURE MANIFOLD ABSOLUTE PRESSURE
SENSORS AND SWITCHES, ENGINE
SHIFTER CAMSHAFT
SHIFTER FORK
SHIFTER, GEAR
SHOCK ABSORBERS, REAR AND AIR SUSPENSION SYSTEM
SOLENOID, AUTO COMPRESSION RELEASE
SOUND SYSTEM - FLHTCUTG (1 OF 2)
SOUND SYSTEM - FLHTCUTG (2 OF 2)
SPARK PLUGS

SPEAKER, FRONT
SPEAKER, REAR
SPEEDOMETER - FLRT
SPROCKET, REAR 70 TEETH
SPROCKET, TRANSMISSION 30 TEETH
STABILIZER LINK, ENGINE
STARTER MOTOR
STATOR
STEERING DAMPER - FLHTCUTG
STEERING DAMPER - FLRT
SWITCH, BANK ANGLE
SWITCH, IGNITION - FLRT
SWITCH, IGNITION
SWITCH, NEUTRAL INDICATOR
SWITCH, OIL PRESSURE
SWITCHES
SWITCHES, HANDLEBAR, LEFT
SWITCHES, HANDLEBAR, RIGHT
TAIL LAMP AND TURN SIGNALS, REAR - DOMESTIC - FLHTCUTG
TAIL LAMP AND TURN SIGNALS, REAR - DOMESTIC - FLRT
TAIL LAMP AND TURN SIGNALS, REAR - HDI - FLHTCUTG
TAIL LAMP AND TURN SIGNALS, REAR - HDI - FLRT
THROTTLE CONTROL
TIRE, FRONT
TIRE, REAR
TOUR-PAK (BOTTOM) - FLHTCUTG
TOUR-PAK (COVER) - FLHTCUTG
TRANSMISSION BEARINGS AND COVERS
TRANSMISSION GEARS
TRANSMISSION HOUSING, TOP COVER AND OIL PAN
TRUNK DOOR - FLHTCUTG (1 OF 2)
TRUNK DOOR - FLHTCUTG (2 OF 2)
TRUNK DOOR - FLRT
TRUNK LINER - FLHTCUTG
TRUNK LINER - FLRT
TURN SIGNALS, FRONT - DOMESTIC - FLHTCUTG
TURN SIGNALS, FRONT - FLRT - DOMESTIC
VALVES
WHEELS, FRONT
WHEELS, REAR
WINDSHIELD, FAIRING AND HEADLAMP - FLHTCUTG
WIRING HARNESS, CONSOLE - FLRT
WIRING HARNESS, FAIRING - FLHTCUTG - DOMESTIC, JAPAN (1 OF 2)
WIRING HARNESS, FAIRING - FLHTCUTG - DOMESTIC, JAPAN (2 OF 2)
WIRING HARNESS, FAIRING - FLHTCUTG - HDI EXCEPT JAPAN (1 OF 2)
WIRING HARNESS, FAIRING - FLHTCUTG - HDI EXCEPT JAPAN (2 OF 2)
WIRING HARNESS, MAIN - FLHTCUTG (1 OF 8)
WIRING HARNESS, MAIN - FLHTCUTG (2 OF 8)
WIRING HARNESS, MAIN - FLHTCUTG (3 OF 8)
WIRING HARNESS, MAIN - FLHTCUTG (4 OF 8)
WIRING HARNESS, MAIN - FLHTCUTG (5 OF 8)
WIRING HARNESS, MAIN - FLHTCUTG (6 OF 8)
WIRING HARNESS, MAIN - FLHTCUTG (7 OF 8)
WIRING HARNESS, MAIN - FLHTCUTG (8 OF 8)
WIRING HARNESS, MAIN - FLRT (1 OF 8)

WIRING HARNESS, MAIN - FLRT (2 OF 8)
WIRING HARNESS, MAIN - FLRT (3 OF 8)
WIRING HARNESS, MAIN - FLRT (4 OF 8)
WIRING HARNESS, MAIN - FLRT (5 OF 8)
WIRING HARNESS, MAIN - FLRT (6 OF 8)
WIRING HARNESS, MAIN - FLRT (7 OF 8)
WIRING HARNESS, MAIN - FLRT (8 OF 8)
WIRING HARNESS, TURN SIGNALS AND LIGHTS, REAR - DOMESTIC - FLHTCUTG
WIRING HARNESS, TURN SIGNALS AND LIGHTS, REAR - DOMESTIC - FLRT
WIRING HARNESS, TURN SIGNALS AND LIGHTS, REAR - HDI - FLHTCUTG
WIRING HARNESS, TURN SIGNALS AND LIGHTS, REAR - HDI - FLRT
Parts

ENGINE ASSEMBLY, AIR-COOLED

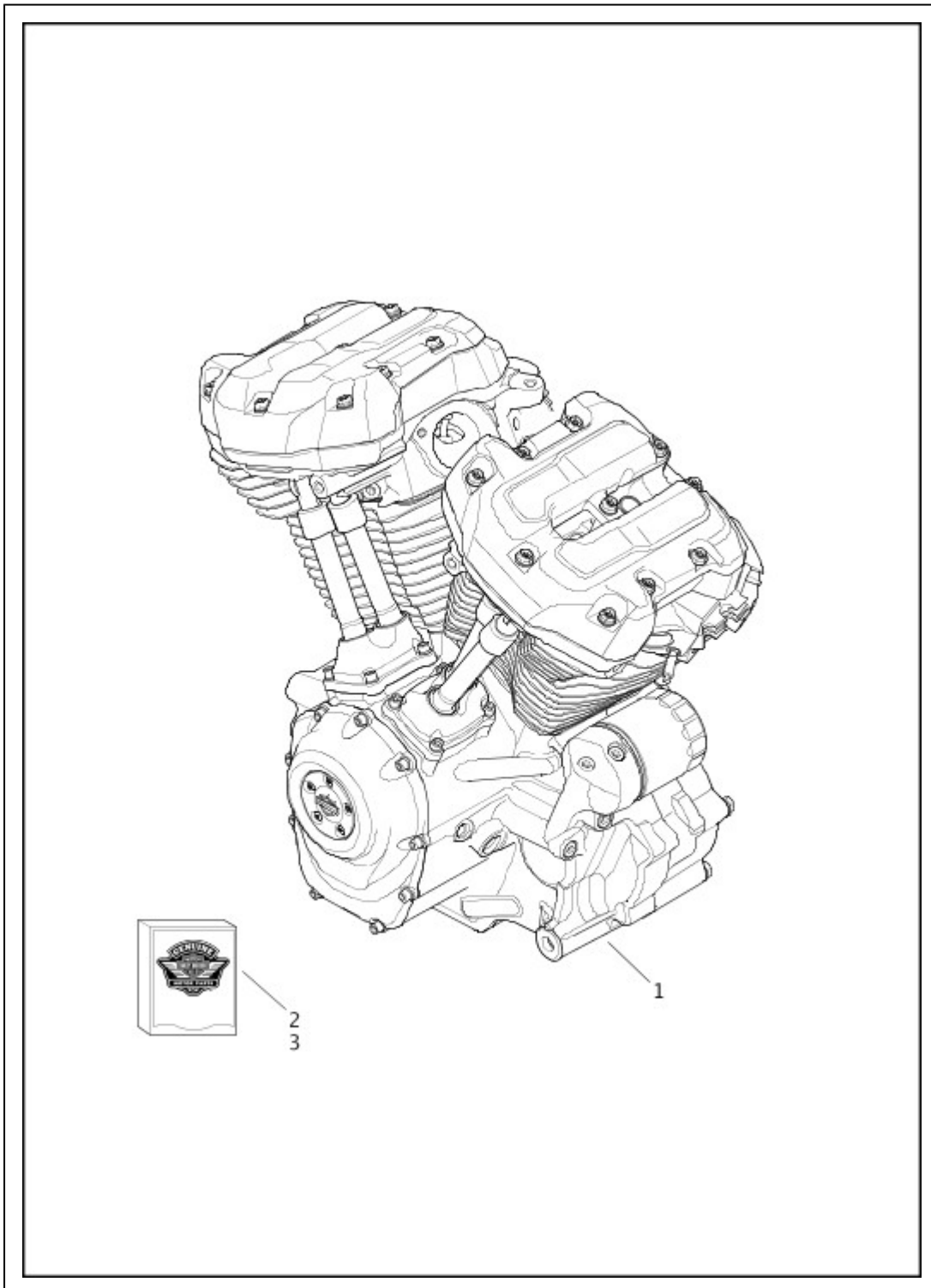

It's a preview. You can download the full file by clicking the link below.

<https://shopservicemanual.com/>

Service Manuals from 2\$