

Document Title: Description	Function Group: 000	Information Type: Service Information	Date: 15-Apr-21
Profile: L110E Volvo			

Description

Showing Selected Profile

Valid for serial numbers			
Model	Production site	Serial number start	Serial number stop
L110E Volvo			

Wheel loaders L110E and L120E are articulated four-wheel drive machines.

The engine is a six-cylinder, four-stroke, direct-injection, turbocharged diesel engine of the D7D type.

The transmission is hydro-mechanical where all gears are in constant mesh and the designation is HTE204 for L110E and HTE205 for L120E.

There is a single-stage hydraulic torque converter between engine and transmission.

Front and rear axles have fully floating axle shafts with planetary gears in the hubs. The front axle is equipped with a differential lock.

The service and parking brakes on the machine are wet type disc brakes.

The service brakes are integrated in the respective wheel hubs and the parking brake is located on the output shaft in the transmission.

The steering system is hydrostatic with a variable load-sensing axial piston pump and two hydraulic cylinders (steering cylinders).

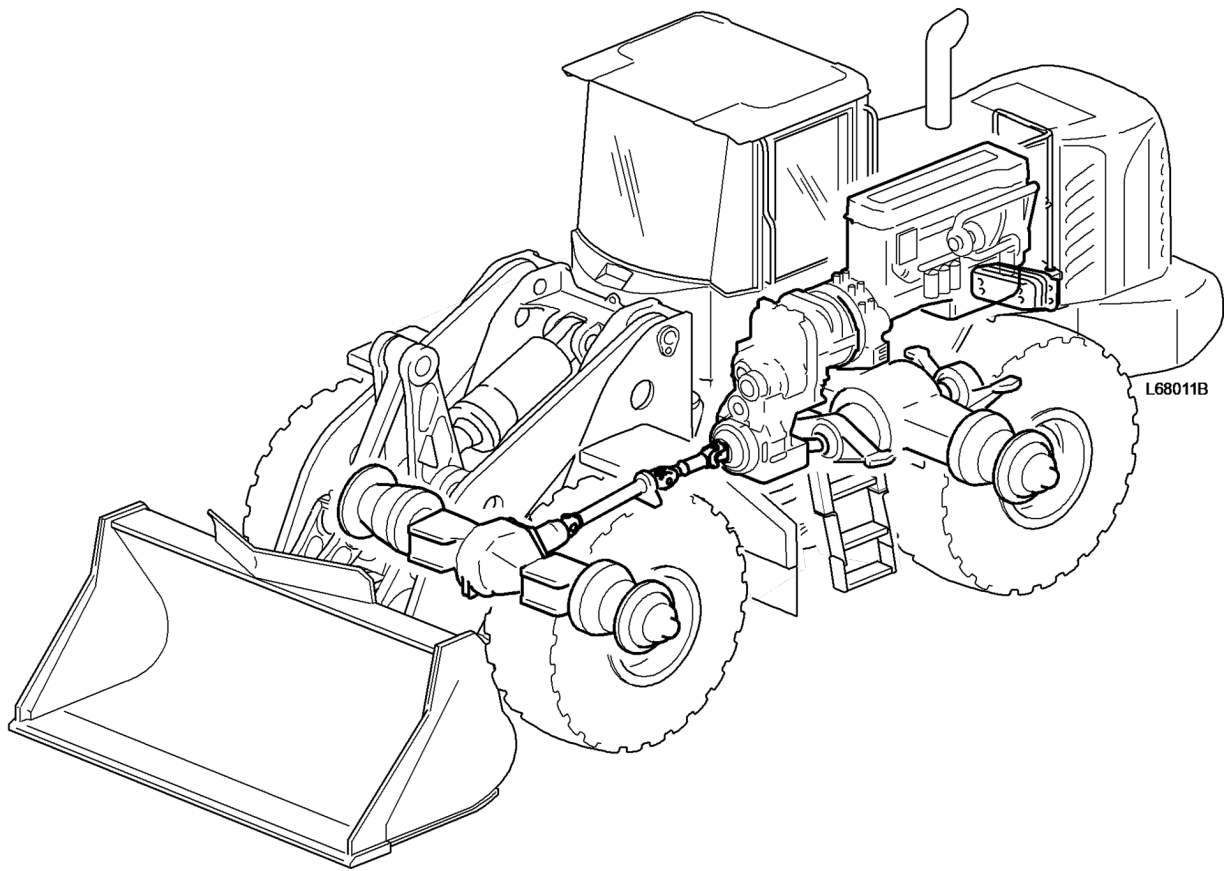

Figure 1

Document Title: Charging batteries	Function Group: 170	Information Type: Service Information	Date: 15-Apr-21
Profile: L110E Volvo			

Charging batteries

Showing Selected Profile

Valid for serial numbers			
Model	Production site	Serial number start	Serial number stop
L110E Volvo			

Explosion hazard

Charging produces hydrogen in the battery, which mixes with oxygen to produce an explosive mixture. A short circuit, naked flame or spark near a battery can cause a powerful explosion. Always switch off the charging current before removing the charger clamps. Ensure appropriate ventilation, especially if the battery is charged in a confined area.

Corrosive sulphuric acid

The battery electrolyte contains corrosive sulphuric acid. Electrolyte spilled on bare skin must be removed immediately. Wash with soap and plenty of water. If electrolyte gets into your eyes or onto any other sensitive part of the body, rinse immediately with plenty of water and seek immediate medical attention.

Document Title: Cleanliness, brake and hydraulic systems	Function Group: 170	Information Type: Service Information	Date: 15-Apr-21
Profile: L110E Volvo			

Cleanliness, brake and hydraulic systems

Showing Selected Profile

Valid for serial numbers			
Model	Production site	Serial number start	Serial number stop
L110E Volvo			

Maintain the best possible cleanliness when working on these systems. Wipe off all pipe and hose connections before disconnecting and remove paint flakes, etc. Plug all pipes, hoses, cylinders, etc. immediately after disconnecting. Never install a hydraulic hose which has not been plugged until it has been thoroughly cleaned.

Document Title: Electric welding	Function Group: 170	Information Type: Service Information	Date: 15-Apr-21
Profile: L110E Volvo			

Electric welding

Showing Selected Profile

Valid for serial numbers			
Model	Production site	Serial number start	Serial number stop
L110E Volvo			

For electric welding on the machine or on attachments on machine:

- ☐ ground connection turned off with battery disconnect switch.
- ☐ fuse FH4 must be removed, located next to the battery disconnect switch.
- ☐ connectors for all control units (ECUs) must be unplugged.

NOTE!

Ground the welding unit as close as possible to the welding point.

It's a preview. You can download the full file by clicking the link below.

<https://shopservicemanual.com/>

Service Manuals from 2\$