

Document Title: Description	Function Group: 000	Information Type: Service Information	Date: 27-Jan-21
Profile: L60E Volvo			

Description

Showing Selected Profile

Valid for serial numbers			
Model	Production site	Serial number start	Serial number stop
L60E Volvo			

Wheel loaders L60E, L70E och L90E have articulated frame steering and four-wheel drive.

The engine is a six-cylinder, four-stroke, direct-injection, turbocharged diesel engine of the type D6D.

The transmission is hydro-mechanical where all gears are in constant mesh. Its type designation is HT93 for L60E, HT95 for L70E and HTE202 for L90E.

There is a single-stage hydraulic torque converter between the engine and the transmission.

Front and rear axles have fully floating drive shafts with planetary gears in the wheel hubs. The front axle is equipped with a differential lock.

The service brakes on these machines are wet type disc brakes. The service brakes are built into each wheel hub.

The parking brake on L60E and L70E is a disc brake positioned externally on the front output shaft of the transmission. On L90E the parking brake is positioned internally on the front output shaft of the transmission.

The steering system is hydrostatic with a variable load-sensing axial piston pump and two hydraulic cylinders (steering cylinders).

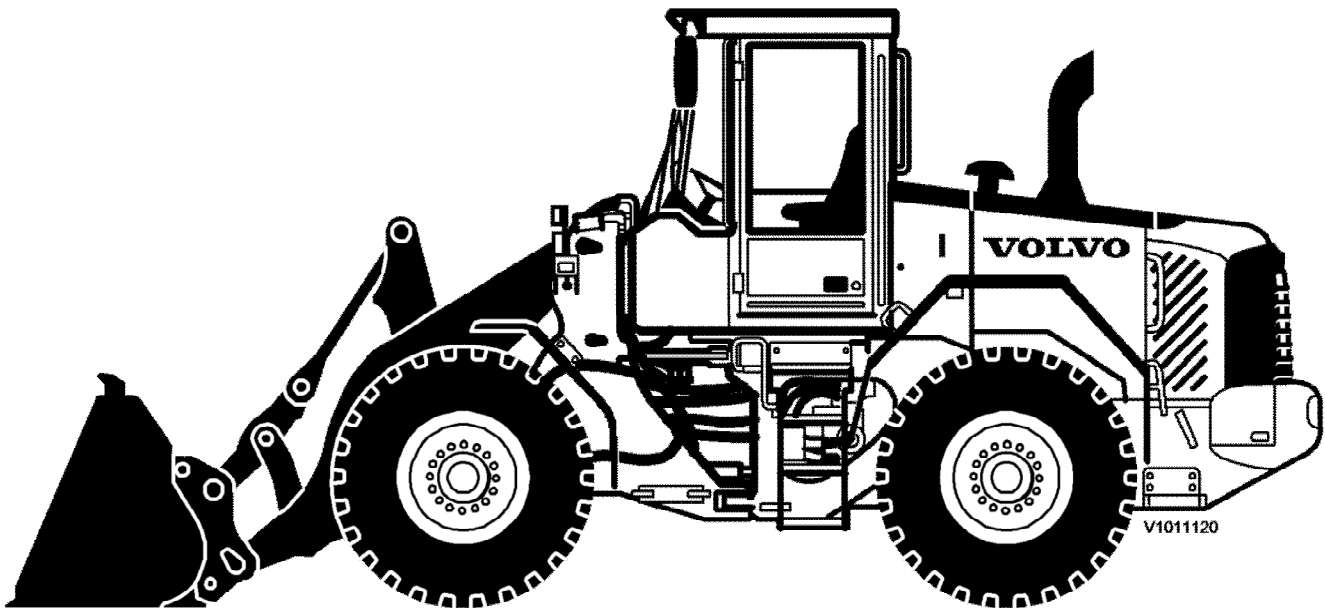

Figure 1

Document Title: Charging batteries	Function Group: 170	Information Type: Service Information	Date: 27-Jan-21
Profile: L60E Volvo			

Charging batteries

Showing Selected Profile

Valid for serial numbers			
Model	Production site	Serial number start	Serial number stop
L60E Volvo			

Explosion hazard

Charging produces hydrogen in the battery, which mixes with oxygen to produce an explosive mixture. A short circuit, naked flame or spark near a battery can cause a powerful explosion. Always switch off the charging current before removing the charger clamps. Ensure appropriate ventilation, especially if the battery is charged in a confined area.

Corrosive sulphuric acid

The battery electrolyte contains corrosive sulphuric acid. Electrolyte spilled on bare skin must be removed immediately. Wash with soap and plenty of water. If electrolyte gets into your eyes or onto any other sensitive part of the body, rinse immediately with plenty of water and seek immediate medical attention.

Document Title: Cleanliness, brake and hydraulic systems	Function Group: 170	Information Type: Service Information	Date: 27-Jan-21
Profile: L60E Volvo			

Cleanliness, brake and hydraulic systems

Showing Selected Profile

Valid for serial numbers			
Model	Production site	Serial number start	Serial number stop
L60E Volvo			

Maintain the best possible cleanliness when working on these systems. Wipe off all pipe and hose connections before disconnecting and remove paint flakes, etc. Plug all pipes, hoses, cylinders, etc. immediately after disconnecting. Never install a hydraulic hose which has not been plugged until it has been thoroughly cleaned.

Document Title: Electric welding	Function Group: 170	Information Type: Service Information	Date: 27-Jan-21
Profile: L60E Volvo			

Electric welding

Showing Selected Profile

Valid for serial numbers			
Model	Production site	Serial number start	Serial number stop
L60E Volvo			

For electric welding on the machine or on attachments on machine:

- ☐ ground connection turned off with battery disconnect switch.
- ☐ fuse FH4 must be removed, located next to the battery disconnect switch.
- ☐ connectors for all control units (ECUs) must be unplugged.

NOTE!

Ground the welding unit as close as possible to the welding point.

Document Title: Parking brake, manually releasing	Function Group: 176	Information Type: Service Information	Date: 27-Jan-21
Profile: L60E Volvo			

Parking brake, manually releasing

Showing Selected Profile

Valid for serial numbers			
Model	Production site	Serial number start	Serial number stop
L60E Volvo			

Op nbr 176-001

If the parking brake cannot be released with the standard switch it can be released manually.
Tools required for releasing the parking brake are included in the machine's tool kit.

- Socket 13/16"
- Allen socket 5/16"
- Ratchet handle
- Adjustable wrench, for removing cover.

NOTE!

This may only be done to permit towing. The parking brake must be restored immediately after towing has been completed.

For restoring manually released parking brake see, [Parking brake, checking wear](#)

WARNING

Park the machine on a level surface. Fit blocks in front of and behind the wheels in order to prevent the machine from rolling.

Remove the brake caliper's cover.

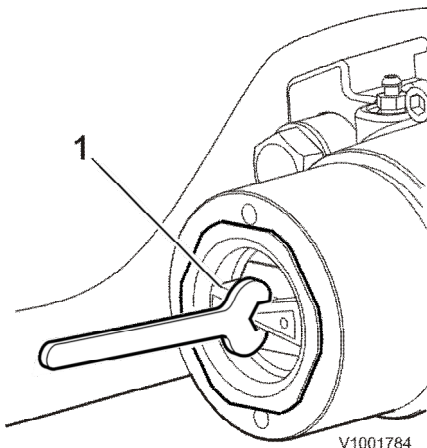

Figure 1

It's a preview. You can download the full file by clicking the link below.

<https://shopservicemanual.com/>

Service Manuals from 2\$