

Document Title: Basic checks	Function Group: 090	Information Type: Service Information	Date: 01-07-2023
Profile: L60F Volvo			

Basic checks

Showing Selected Profile

Valid for serial numbers			
Model	Production site	Serial number start	Serial number stop
L60F Volvo	Arvika	4001	9999
L60F Volvo	Asheville	61401	69999
L60F Volvo	Pederneiras	70601	79999

NOTE!

Basic data must always be collected and error codes and parameters must always be checked before the basic check is started; see [Troubleshooting, general](#).

Basic check is performed on each main system. The purpose of the basic check is that it shall give quick and certain information about the status in the sub-system included in each main system.

Each basic check is divided into a number of checks to be performed in order.

If the basic check does not help to locate the cause of the malfunction, the information obtained helps as guidance for continued troubleshooting together with other service information.

The basic check(s) to be performed is determined by the information obtained when the basic data was collected; see [Collection of basic data](#).

Basic checks:

- [Engine, basic check](#)
- [Electrical system, basic check](#)
- [Power transmission, basic check](#)
- [Brake system, basic check](#)
- [Parking brake, basic check](#)
- [Steering and hydraulics, basic check](#)



Construction Equipment

Service Information

Document Title: Electric welding	Function Group: 179	Information Type: Service Information	Date: 01-07-2023
Profile: L60F Volvo			

Electric welding

Showing Selected Profile

Valid for serial numbers			
Model	Production site	Serial number start	Serial number stop
L60F Volvo			

The battery disconnect switch must be turned off or the battery ground lead must be disconnected before any electric welding on the machine or connected attachments is carried out.

Connect the welding unit as close as possible to the welding point.

Document Title: Parking brake, manually releasing	Function Group: 176	Information Type: Service Information	Date: 01-07-2023
Profile: L60F Volvo			

Parking brake, manually releasing

Showing Selected Profile

Valid for serial numbers			
Model	Production site	Serial number start	Serial number stop
L60F Volvo	Arvika	4001	5032
L60F Volvo	Asheville	61401	61758
L60F Volvo	Pederneiras	70601	70891

Op nbr 176-001

If the parking brake cannot be released with the standard switch it can be released manually.
Tools required for releasing the parking brake are included in the machine's tool kit.

- Socket 13/16"
- Allen socket 5/16"
- Ratchet handle
- Adjustable wrench, for removing cover.

NOTE!

This may only be done to permit towing. The parking brake must be restored immediately after towing has been completed.

For restoring manually released parking brake see, [Parking brake, checking wear](#)



WARNING

Park the machine on a level surface. Fit blocks in front of and behind the wheels in order to prevent the machine from rolling.

Remove the brake caliper's cover.

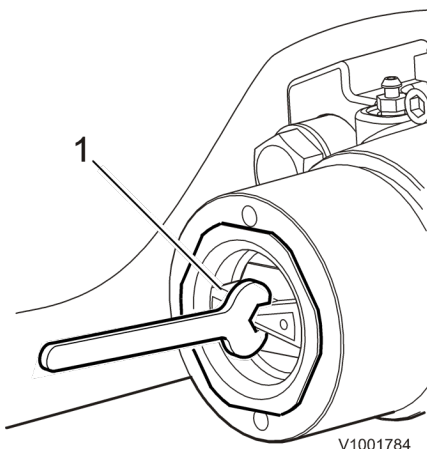

V1001784

Figure 1

Loosen the lock nut and screw it out 1/2 turn.

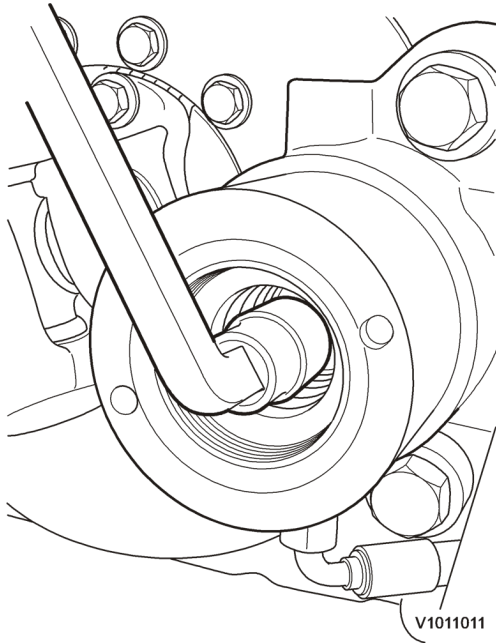

Figure 2

Screw out the brake piston's adjusting screw (approx. two turns) until the brake pads' contact releases from the brake disc.

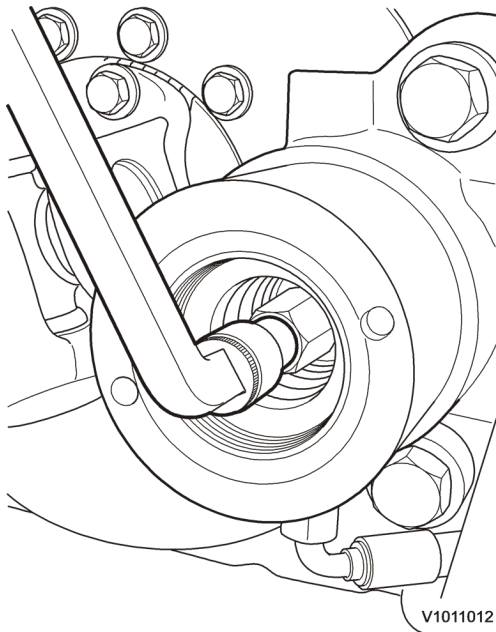

Figure 3

Now the machine can be moved, but the parking brake does not work.

Document Title: Charging batteries	Function Group: 170	Information Type: Service Information	Date: 01-07-2023
Profile: L60F Volvo			

Charging batteries

Showing Selected Profile

Valid for serial numbers			
Model	Production site	Serial number start	Serial number stop
L60F Volvo			

Explosion hazard

Charging produces hydrogen in the battery, which mixes with oxygen to produce an explosive mixture. A short circuit, naked flame or spark near a battery can cause a powerful explosion. Always switch off the charging current before removing the charger clamps. Ensure appropriate ventilation, especially if the battery is charged in a confined area.

Corrosive sulphuric acid

The battery electrolyte contains corrosive sulphuric acid. Electrolyte spilled on bare skin must be removed immediately. Wash with soap and plenty of water. If electrolyte gets into your eyes or onto any other sensitive part of the body, rinse immediately with plenty of water and seek immediate medical attention.

It's a preview. You can download the full file by clicking the link below.

<https://shopservicemanual.com/>

Service Manuals from 2\$