

|  |                               |   |                            |
|--|-------------------------------|---|----------------------------|
| Document Title:<br><b>Basic checks</b> | Function Group:<br><b>090</b> | Information Type:<br><b>Service Information</b> | Date:<br><b>06-10-2022</b> |
| Profile:<br><b>L70F Volvo</b>          |                               |   |                            |

## Basic checks

Showing Selected Profile

| Valid for serial numbers |                 |                     |                    |
|--------------------------|-----------------|---------------------|--------------------|
| Model                    | Production site | Serial number start | Serial number stop |
| L70F Volvo               |                 |                     |                    |

### NOTE!

Basic data must always be collected and error codes and parameters must always be checked before the basic check is started; see [Troubleshooting, general](#).

Basic check is performed on each main system. The purpose of the basic check is that it shall give quick and certain information about the status in the sub-system included in each main system.

Each basic check is divided into a number of checks to be performed in order.

If the basic check does not help to locate the cause of the malfunction, the information obtained helps as guidance for continued troubleshooting together with other service information.

The basic check(s) to be performed is determined by the information obtained when the basic data was collected; see [Collection of basic data](#).

### Basic checks:

- [Engine, basic check](#)
- [Electrical system, basic check](#)
- [Power transmission, basic check](#)
- [Brake system, basic check](#)
- [Parking brake, basic check](#)
- [Steering and hydraulics, basic check](#)

|  |                               |   |                            |
|--|-------------------------------|---|----------------------------|
| Document Title:<br><b>Electric welding</b> | Function Group:<br><b>179</b> | Information Type:<br><b>Service Information</b> | Date:<br><b>07-10-2022</b> |
| Profile:<br><b>L70F Volvo</b>              |                               |   |                            |

## Electric welding

Showing Selected Profile

| Valid for serial numbers |                 |                     |                    |
|--------------------------|-----------------|---------------------|--------------------|
| Model                    | Production site | Serial number start | Serial number stop |
| L70F Volvo               |                 |                     |                    |

The battery disconnect switch must be turned off or the battery ground lead must be disconnected before any electric welding on the machine or connected attachments is carried out.

**Connect the welding unit as close as possible to the welding point.**

|   |                               |   |                            |
|---|-------------------------------|---|----------------------------|
| Document Title:<br><b>Parking brake, manually releasing</b> | Function Group:<br><b>176</b> | Information Type:<br><b>Service Information</b> | Date:<br><b>07-10-2022</b> |
| Profile:<br><b>L70F Volvo</b>                               |                               |   |                            |

## Parking brake, manually releasing

Showing Selected Profile

| Valid for serial numbers |                 |                     |                    |
|--------------------------|-----------------|---------------------|--------------------|
| Model                    | Production site | Serial number start | Serial number stop |
| L70F Volvo               | Arvika          | 24001               | 24970              |
| L70F Volvo               | Asheville       | 61801               | 62371              |
| L70F Volvo               | Pederneiras     | 71401               | 71600              |

### Op nbr 176-001

If the parking brake cannot be released with the standard switch it can be released manually.  
Tools required for releasing the parking brake are included in the machine's tool kit.

- Socket 13/16"
- Allen socket 5/16"
- Ratchet handle
- Adjustable wrench, for removing cover.

### NOTE!

This may only be done to permit towing. The parking brake must be restored immediately after towing has been completed.

For restoring manually released parking brake see, [Parking brake, checking wear](#)

### WARNING

**Park the machine on a level surface. Fit blocks in front of and behind the wheels in order to prevent the machine from rolling.**

Remove the brake caliper's cover.

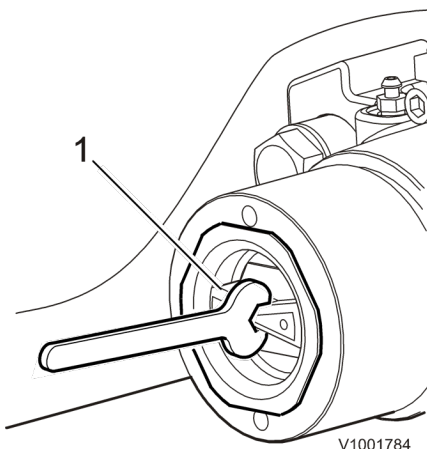

V1001784

**Figure 1**

Loosen the lock nut and screw it out 1/2 turn.

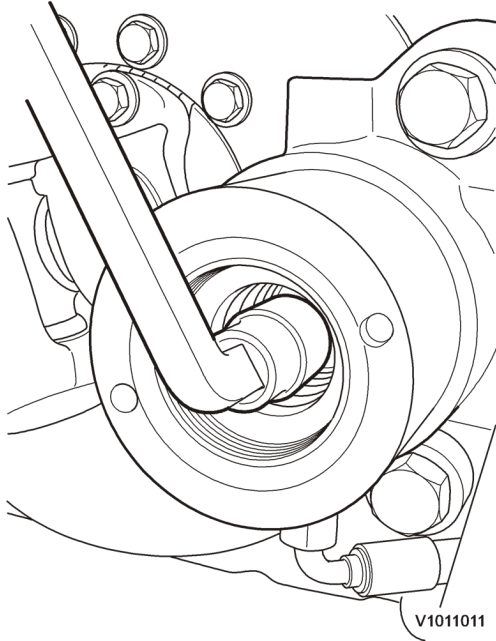

**Figure 2**

Screw out the brake piston's adjusting screw (approx. two turns) until the brake pads' contact releases from the brake disc.

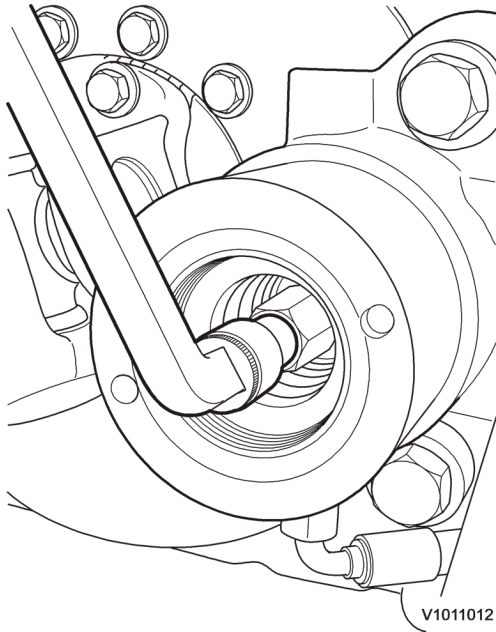

**Figure 3**

Now the machine can be moved, but the parking brake does not work.

|  |                               |   |                            |
|--|-------------------------------|---|----------------------------|
| Document Title:<br><b>Charging batteries</b> | Function Group:<br><b>170</b> | Information Type:<br><b>Service Information</b> | Date:<br><b>07-10-2022</b> |
| Profile:<br><b>L70F Volvo</b>                |                               |   |                            |

## Charging batteries

Showing Selected Profile

| Valid for serial numbers |                 |                     |                    |
|--------------------------|-----------------|---------------------|--------------------|
| Model                    | Production site | Serial number start | Serial number stop |
| L70F Volvo               |                 |                     |                    |

### Explosion hazard

Charging produces hydrogen in the battery, which mixes with oxygen to produce an explosive mixture. A short circuit, naked flame or spark near a battery can cause a powerful explosion. Always switch off the charging current before removing the charger clamps. Ensure appropriate ventilation, especially if the battery is charged in a confined area.

### Corrosive sulphuric acid

The battery electrolyte contains corrosive sulphuric acid. Electrolyte spilled on bare skin must be removed immediately. Wash with soap and plenty of water. If electrolyte gets into your eyes or onto any other sensitive part of the body, rinse immediately with plenty of water and seek immediate medical attention.

It's a preview. You can download the full file by clicking the link below.

<https://shopservicemanual.com/>

Service Manuals from 2\$