

# WSM

---

WORKSHOP MANUAL  
**TRACTOR**

**B3000-AUS**

---

**Kubota**

# TO THE READER

This Workshop Manual tells the servicing personnel about the mechanism, servicing and maintenance of the B3000-AUS. It contains 4 parts: **"Information"**, **"General"**, **"Mechanism"** and **"Servicing"**.

## ■ Information

This section primarily contains information below.

- Safety First
- Safety Decal
- Specification
- Dimension

## ■ General

This section primarily contains information below.

- Engine Identification
- Model Identification
- General Precautions
- Maintenance Check List
- Check and Maintenance
- Special Tools

## ■ Mechanism

This section contains information on the structure and the function of the unit. Before you continue with the subsequent sections, make sure that you read this section.

Refer to the latest version of Workshop Manual (Code No. 9Y021-01870 / 9Y021-18200) for the diesel engine / tractor mechanism that this workshop manual does not include.

## ■ Servicing

This section primarily contains information below.

- Troubleshooting
- Servicing Specifications
- Tightening Torques
- Checking, Disassembling and Servicing

All illustrations, photographs and specifications contained in this manual are of the newest information available at the time of publication.

KUBOTA reserves the right to change all information at any time without notice.

**November, 2011**

**© KUBOTA Corporation 2011**

# I INFORMATION

# INFORMATION

## CONTENTS

|                          |      |
|--------------------------|------|
| 1. SAFETY FIAT.....      | I-1  |
| 2. SAFETY DECALS .....   | I-4  |
| 3. SPECIFICATIONS.....   | I-8  |
| 4. TRAVELING SPEEDS..... | I-9  |
| 5. DIMENSIONS .....      | I-10 |

# 1. SAFETY FIAST

## SAFETY FIRST

- This symbol, the industry's "Safety Alert Symbol", is used throughout this manual and on labels on the machine itself to warn of the possibility of personal injury. Read these instructions carefully.
- It is essential that you read the instructions and safety regulations before you attempt to repair or use this unit.



### DANGER

- Indicates an imminently hazardous situation which, if not avoided, will result in death or serious injury.



### WARNING

- Indicates a potentially hazardous situation which, if not avoided, could result in death or serious injury.



### CAUTION

- Indicates a potentially hazardous situation which, if not avoided, may result in minor or moderate injury.

### ■ IMPORTANT

- Indicates that equipment or property damage could result if instructions are not followed.

### ■ NOTE

- Gives helpful information.

WSM000001INI0001US1

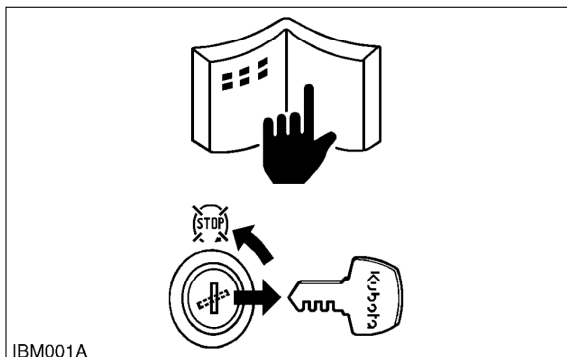

IBM001A

### BEFORE YOU START SERVICE

- Read all instructions and safety instructions in this manual and on your machine safety decals.
- Clean the work area and machine.
- Park the machine on a stable and level ground, and set the parking brake.
- Lower the implement to the ground.
- Stop the engine, then remove the key.
- Disconnect the battery negative cable.
- Hang a **"DO NOT OPERATE"** tag in the operator station.

WSM000001INI0010US1

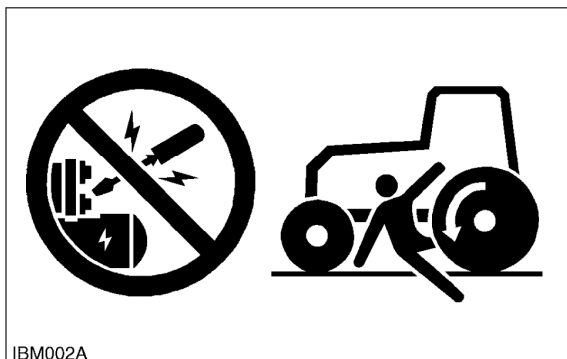

IBM002A

### START SAFELY

- Do not do the procedures below when you start the engine.
  - short across starter terminals
  - bypass the safety start switch
- Do not alter or remove any part of machine safety system.
- Before you start the engine, make sure that all shift levers are in neutral positions or in disengaged positions.
- Do not start the engine when you stay on the ground. Start the engine only from operator's seat.

WSM000001INI0015US0

It's a preview. You can download the full file by clicking the link below.

<https://shopservicemanual.com/>

Service Manuals from 2\$