

**SL50 TR**  
COMPACT WHEEL LOADER

SERVICE MANUAL

**Part number 92086720**

English  
March 2024



# CASE

## CONSTRUCTION

### SERVICE MANUAL

#### SL50 TR

#### COMPACT WHEEL LOADER

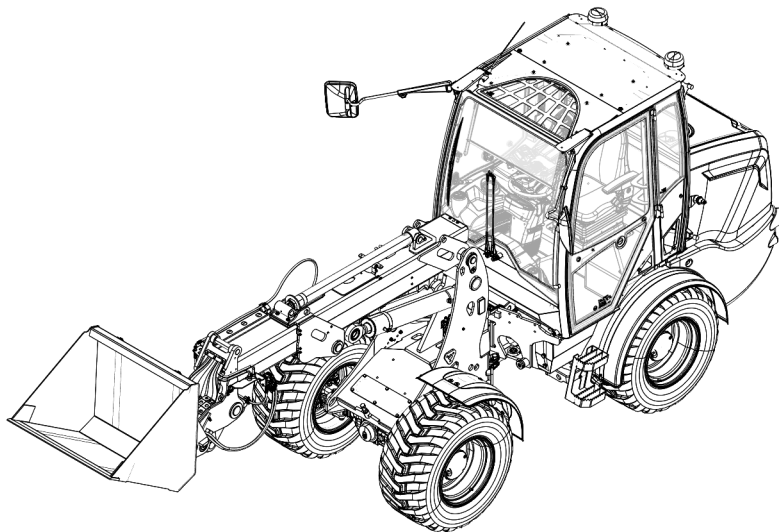

EN-US - Original Manual

**WARNING**

Please read this manual carefully and understand the contents. Failure to read the manual can result in serious damage, injury or death. Make sure that all service engineers have read and understand the contents of this manual.

**WARNING**

Preposition 65: diesel engine exhaust and some of its constituents are known to the State of California to cause cancer, birth defects, or other reproductive harm.

Copyright © CNH Industrial America LLC.

CNH Industrial America LLC reserves the right to change specifications and or spare parts without prior notice. The content of this manual can also be changed without prior notice.

CNH Industrial America LLC accepts no liability for damage and/or problems arising from the use of parts not supplied by CNH Industrial America LLC.

This manual has been compiled with all possible care. CNH Industrial America LLC assumes no responsibility for any errors in this manual and/or the consequences of an erroneous interpretation of the instructions.

All rights reserved. No parts of this publication are allowed to be reproduced, stored in computerised databases, or made public, in any form or by any means, either electronic, mechanical, through photocopying of otherwise, without the prior written consent of CNH Industrial America LLC. This also applies to the associated drawings and diagrams.

# Preface

This document is only applicable for these Compact Wheel Loader models, from here on in the document referred to as the machine:

- SL50 TR

This document is designed for approved service engineers and provides the information necessary to keep the machine serviceable.



The general safety instructions are printed in the document: OPM\_SL50 TR. This document SVM\_SL50 TR only contains additional safety instructions.



- This document can only be used by approved service engineers.
- Make sure that the service engineer understands the structure and contents of this document.
- Read the safety chapter in detail and make sure that all instructions are known and understood.
- Perform the steps in the procedures fully and in the correct sequence.
- Only perform the procedures and only read the chapters of the OEM documentation this document refers to. It is possible that other parts are unrelated to the machine.



In general, this document contains no information that is mentioned in the document OPM\_SL50 TR. Therefore, make sure that the service engineer has read and understood the document OPM\_SL50 TR.

## Language



If this machine is located in the United States of America:

- Only use the EN-US version of this document to use the machine or perform maintenance on the machine.
- If this document is not the EN-US version, please ask the CNH Industrial America LLC dealer for an EN-US copy.
- The original instructions in this document are created in English (EN-GB). All other language versions are translations of the original instructions. In the event of ambiguity and/or disputes, the English (EN-GB) text always takes precedence.

## Related documents

Document name	Document code	Target group
Operator manual	OPM_SL50 TR	Approved operators
Operator manual	OPM_TOBIAS	Approved service engineers
Service manual	SVM_SL50 TR	Approved service engineers

Document name	Document code	Target group
Parts manual	PAM_SL50 TR	Approved service engineers
Hydraulic diagram	HYD_SL50 TR	Approved service engineers
Electrical diagram	ELD_SL50 TR	Approved service engineers
Diagnostic trouble codes	DTC_SL50 TR	Approved service engineers
OEM documentation	OEM_SL50 TR	Approved service engineers

## OEM documentation overview

Component name	Model	Supplier name	Type of document
Engine, including all parts	V3307-CR-TE5B-BRO	Kubota	Workshop manual
Drive pump	A4VG56DA1D8/32R	Bosch Rexroth	Repair manual
Drive motor	A6VM80EP/65	Bosch Rexroth	Repair manual
Axles, brakes and gear-box	F128	Comer	Service manual
Work pump	34 cm <sup>3</sup>	Jihostroj	Seal change
Work pump	34 cm <sup>3</sup> + 19 cm <sup>3</sup>	Jihostroj	Seal change

## Icons and signal words used in the document



Warns about a situation that will cause death, serious physical injury and/or heavy material damage if one does not obey the safety instructions.



Warns about a situation that can cause death, serious physical injury and/or heavy material damage if one does not obey the safety instructions.



Warns about a situation that can cause material damage if one does not follow the safety instructions.



Provides additional information that is helpful to do a task or to avoid problems.



This symbol indicates required tools.



This symbol indicates required parts.

It's a preview. You can download the full file by clicking the link below.

<https://shopservicemanual.com/>

Service Manuals from 2\$